

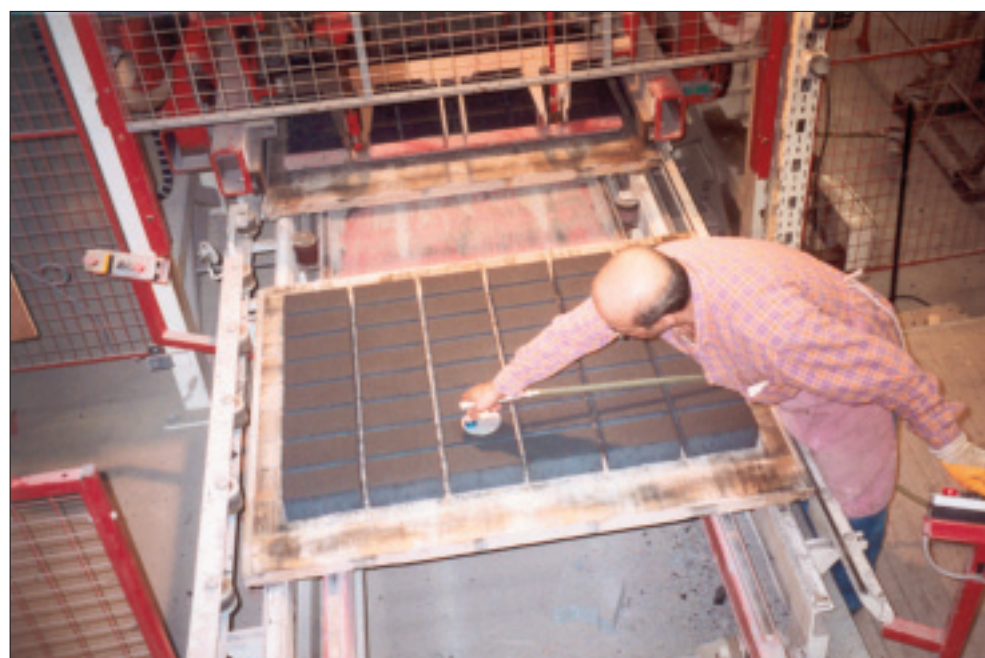

Basic equipment with generator and safety package with suspension for hoisting operation.

Basic equipment with carrying module and 2 suction pads, safety package with suspension for hoisting operation.



Quality control in a production line of concrete stones.

Basic equipment with undercarriage and Einstein lifter.



Basic equipment + Safety package + Generator + Carrying module + Suction pad



Einstein 2 lifter



Basic equipment with 2 men lifter and suction pad 2



Basic equipment with suction pad SP 1000

The universal lifter is of modular construction: For manual and machine hoisting operation

You are looking for a vacuum lifter for manual operation, but you want to lift heavy blocks using your excavator as well?

No problem with our Uni-Levator.

The Uni-Levator is of modular construction for nearly any kind of operation and material, like natural and concrete stones. The powerful pump controls difficult material and surfaces, like e.g. steps or kerbstones. The single components are quickly exchangeable.

The plates are manually applicable?

No problem; just take the basic equipment, which can be equipped with four wheels for easy movement, connect e.g. the two men lifter frame to the hose pipe of 5 m length. Where no mains are available, just use the generator.

The Uni-Levator must only be used close to the ground (max 1.8 m above ground). According to EN 13155 the vacuum lifter must be additionally equipped with a form-locking holding device (eg. with two safety chains) during operation on site.

The plates are machine applicable?

Also no problem. Take your basic equipment, suction pad, safety package and the generator, if necessary. Fit in the load hook and start.

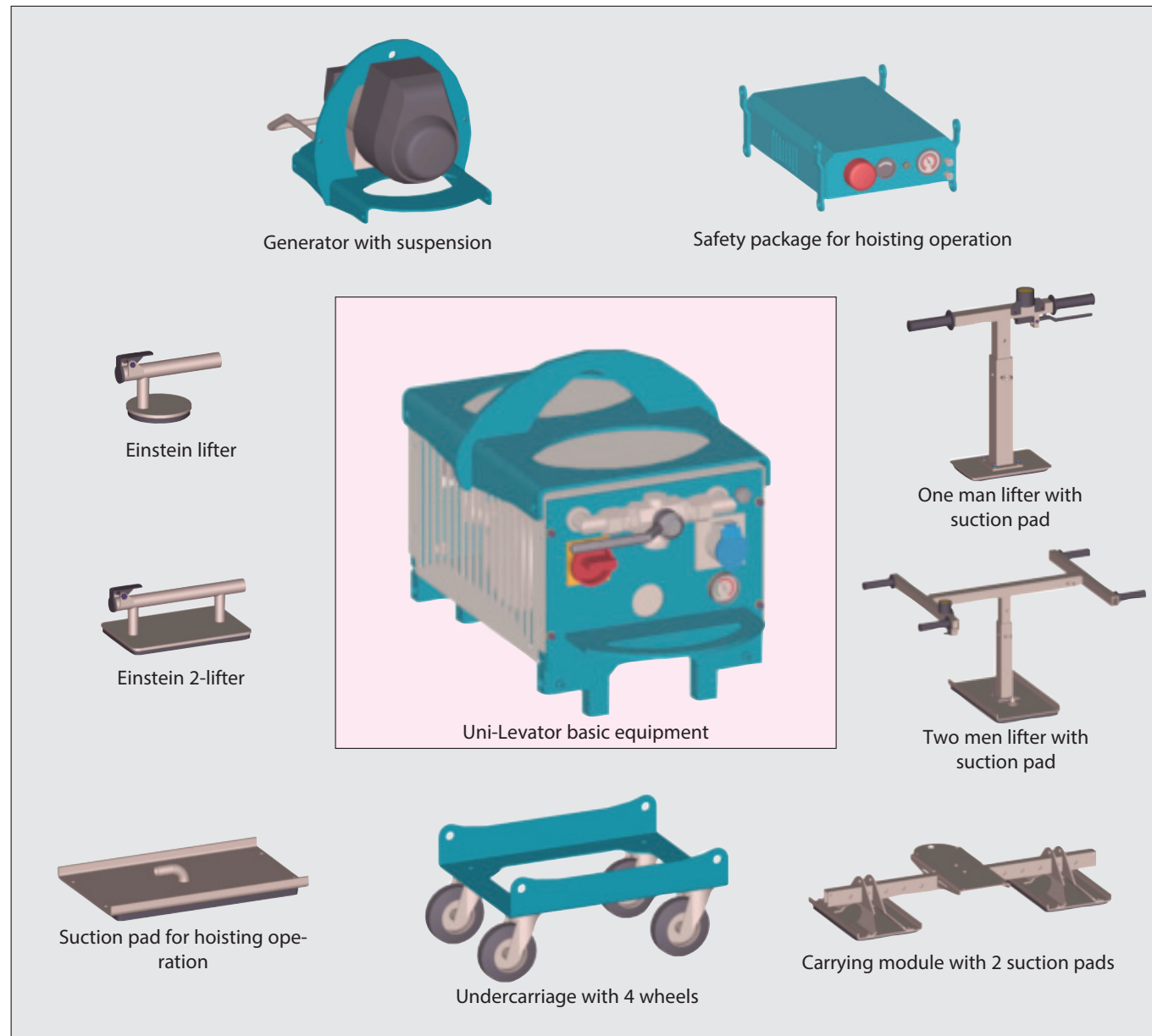

Specification

Order No.

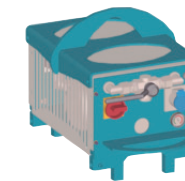

Uni-Levator

Basic equipment with 10 m feeding cable and suspension, electric mains 230 V - 50 Hz, the vane-type rotary pump is designed for permanent use and reaches 95% vacuum. Furthermore it is very quietly running and low vibration 60dB(A). Carrying capacity up to 1.0 t, depending on the carrying module, suction pads and material.

Dimensions 600 x 350 x 400 mm - 60 kg

840 100

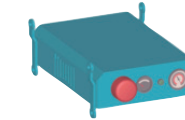

Safety package for hoisting operation

Visual and acoustic warning sign, vacuum storage, manometer, voltmeter.

470 x 350 x 120 mm - 20 kg

840 200



Generator with suspension

Honda petrol engine with generator 1.5 KVA, 230 V - 50 Hz, manually operated starting.

500 x 400 x 400 mm - 40 kg

840 300



Undercarriage with 4 wheels

for easy movement. 2 wheels equipped with wheel stop.

840 110

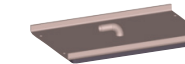

Suction pad SP 400 for hoisting operation

Carrying capacity 400 kg² / 200 kg¹
275 x 460 mm - 7 kg

840 150



Carrying module with 2 suction pads SP 400

Carrying capacity 800 kg² / 400 kg¹, length of beam 1.500 mm, suction pads turn through 90°. Dimension of suction pad 275 x 460 mm

840 160



Suction pad SP 1000 for hoisting operation

Carrying capacity 1,000 kg², suction pad 650 x 650 mm.

840 163



One man lifter

Height adjustable, aluminium construction with 5 m hose pipe

840 121



Two men lifter

Height and width adjustable, aluminium construction with 5 m hose pipe

840 131

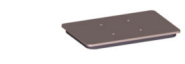

Suction pad SP 50 for one man lifter and two men lifter

Carrying capacity 50 kg¹, 150 x 230 mm

840 142

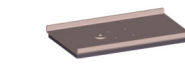

Suction pad SP 150 for one man lifter and two men lifter

Carrying capacity 150 kg¹, 275 x 425 mm

840 151



Einstein lifter SP 15

with 5 m hose pipe, suction pad Ø 105 mm, carrying capacity 15 kg¹

840 170



Einstein 2 lifter SP 50

with 5 m hose pipe, suction pad 155 x 235 mm, carrying capacity 50 kg¹

840 171

Safety chains for suction pad 275 x 460 mm

840 401

Safety chains for suction pad 650 x 650 mm

840 402

Special accessories like tie bars and suction pads with higher capacities or suction pads for preforms on request.

¹ in case of low pressure of at least -0.6 bar, ² in case of low pressure of at least -0.9 bar